

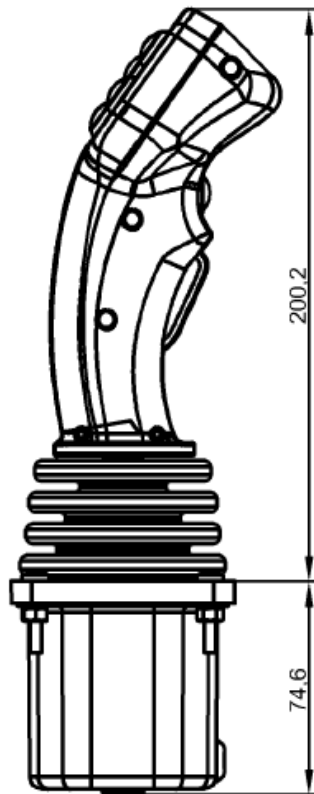

**JAV90 Series  
Hall Effect  
Industrial Joystick**

## JAV90 Industrial Joystick Series

- Ergonomic design, hand-operated
- Single axis or multi-axis operation, spring return
- Robust joystick, applicable in harsh environment
- Contactless **Hall Effect** technology, high reliability, very long lifetime
- Configured with 2A@30Vdc micro switches, independent on-off output
- Optional **CANbus** output interface
- Drive proportional valve and switch valve, achieve electro-hydraulic control function
- Applicable in various off-road vehicles, hoisting machinery, agriculture machinery, road machinery, earth-moving machinery etc.
- **Not a programmable control unit. Must be used with valve/motor driver unit or relay.**



## Technical Specifications

### Mechanical Data

- Movement Angle  $\pm 20^\circ$
- Operating Force 10-20N
- Maximum Allowable Force 300N
- Lifetime 5 million cycles
- Weight 850g

### Electrical Data

- Supply Voltage: 9-32Vdc
- Power Current consumption <9mA (per channel)
- Signal type: 0.5 - 4.5Vdc (Center Voltage  $2.5 \pm 0.1V$ )
- Optional Sgnal Type: 4..20mA, 0..10Vdc, -10..+10Vdc
- Output Linearity Error  $\pm 3\%$
- Maximum Overload Voltage 30Vdc
- Maximum Reverse Voltage -15Vdc
- Load Resistance >10K $\Omega$
- Insulation Resistance >1000M $\Omega$
- EMC 100V/m
- Power Current consumption <35mA

### Position Micro Switch

- Configuration 2 micro switches per axis, normal open
- Start Angle  $2^\circ \sim 5^\circ$
- Load Capacity 3A@125Vac ; 2A@30Vdc
- Lifetime 1,000,000 cycles

### Optional CAN bus

- Supply Voltage 9-36Vdc
- Power Current 120mA
- CAN Version CAN2.0B
- CAN Protocol J1939
- Baud Rate 125Kbps-1Mbps (the default value 250kbps)

### Environmental Data

- Operating Temperature  $-30^\circ C \sim +70^\circ C$
- Storage Temperature  $-40^\circ C \sim +85^\circ C$
- Protection Class IP65, above the panel



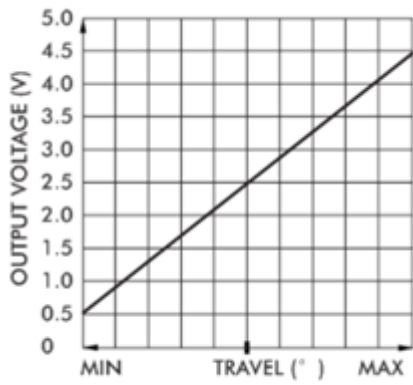

Signal Curve

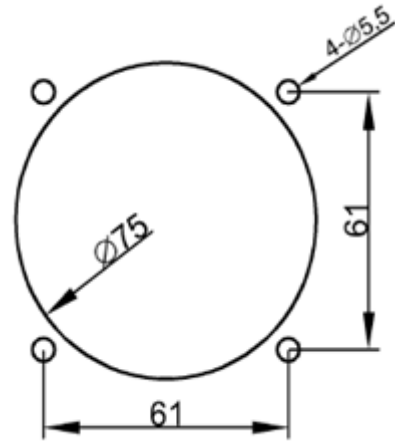

Mounting Hole

